

# 4-Part Timber Doorframe

# FD120 (FCH)

DFT1044P

## Isometric

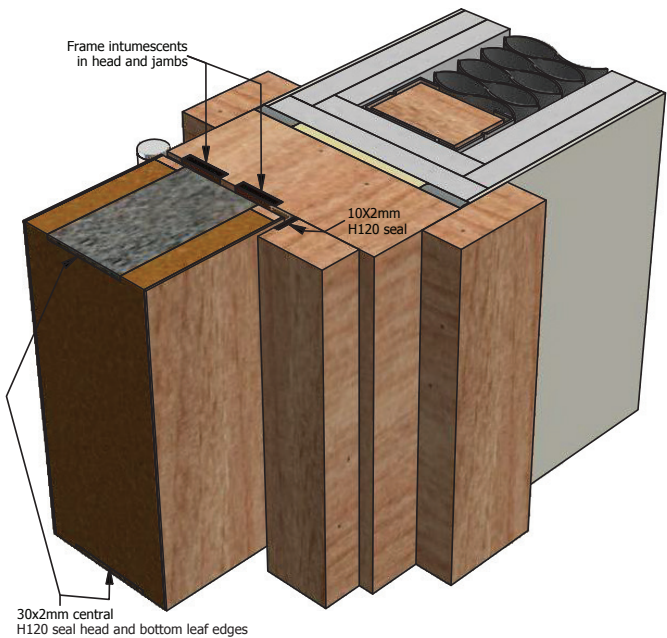

## Head / Jamb Joint

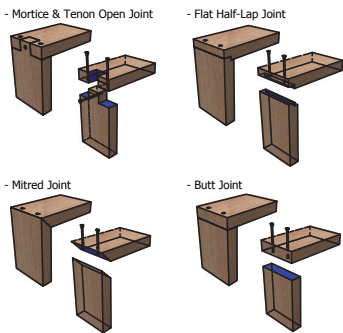

## Both Vertical Door Leaf Edges Seal

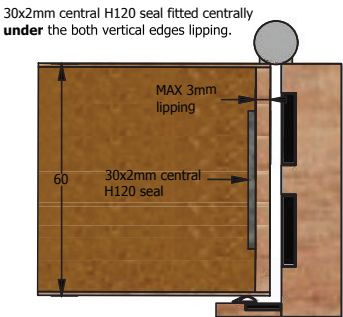

## Dimensions (Jambs and Head)

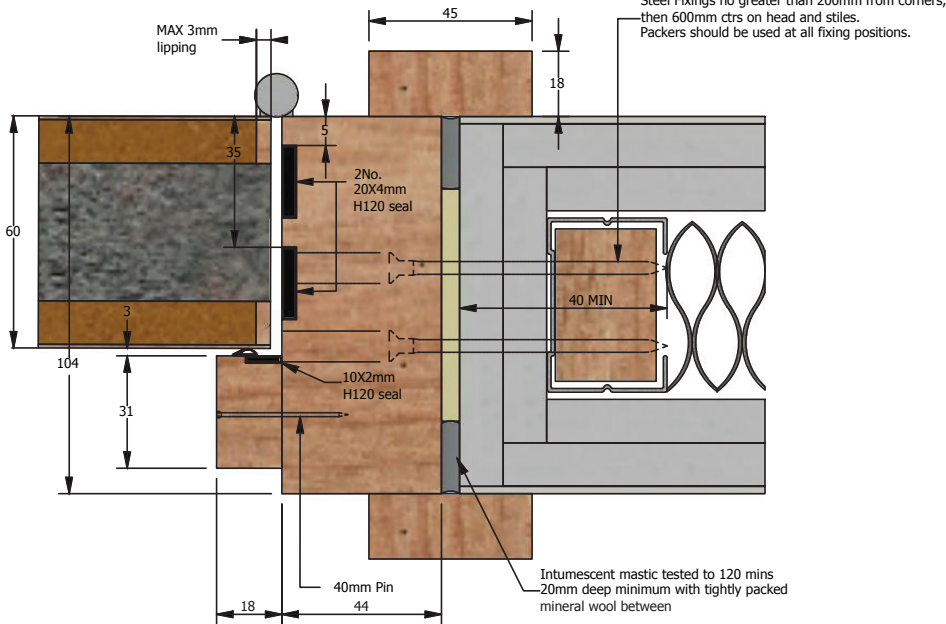

forza-doors.com  
01403 711 126  
info@forza-doors.com

TITLE	4-Part Timber Doorframe
CODE	DFT1044P FD120 (FCH)
SHEET	1 of 1
DATE	16/02/2024
ISSUE	4
DWG No.	FZD0480

DOOR	FCH120
LINER	Solid Timber minimum density 640kg/m <sup>3</sup>
STOP/ARCHITRAVE	Solid Timber
FINISH	Precatalyst Lacquer
LIPPING	Solid Timber - Finish max. 3mm edge lippings
SEALS	25x4mm, 20x4mm, 50x2mm, ST1009