

FD30 FIRE DOOR EXPANDING FOAM

STEEL/TIMBER STUD PARTITION OR MASONRY WALL

FD30 Door Steel/Timber Stud. Partition

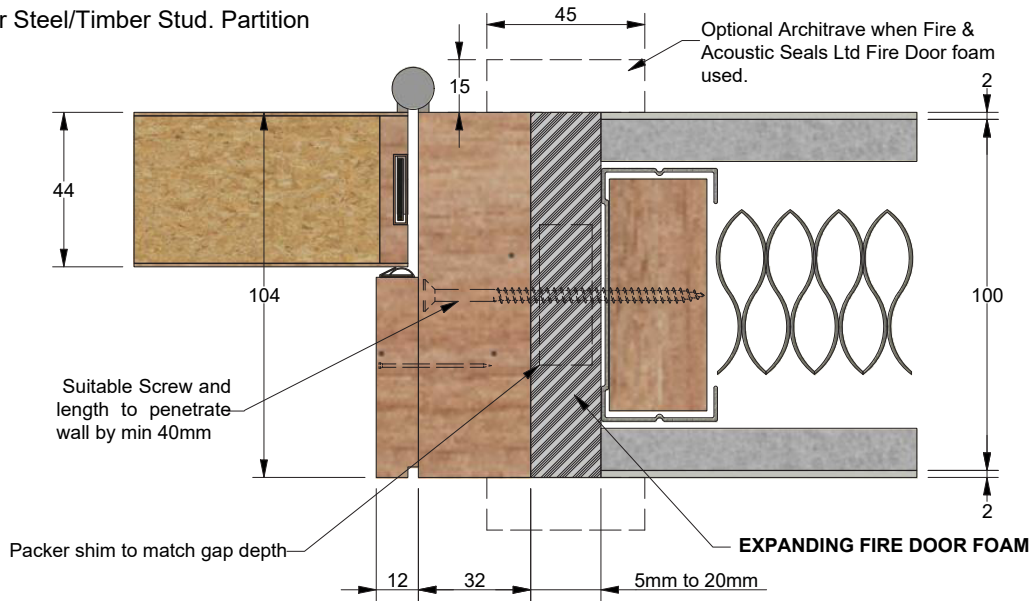

***Forza Recommended Foams:**

Fire And Acoustic Seals Ltd. > Fire Door Foam: Hardwood / Softwood With or Without Architraves. (MDF With 19mm Architraves) Sealed Tight Solutions Ltd. > ST99 FR Expanding Foam: Only With Architraves. (Max Gap 10mm)

Other manufacturers foams that have been tested in accordance with BS476-20 or BS EN 1366-4 in suitable supporting constructions with or without architraves may be suitable. (contact the foam supplier / manufacturer for evidence)

FD30 Door Masonry Wall

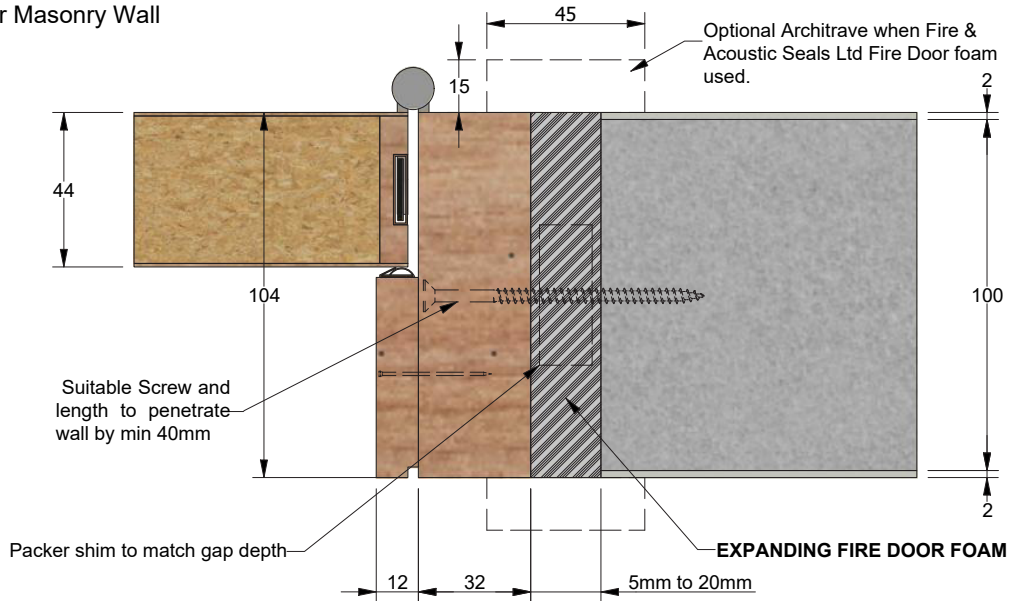

Specification

Door:	Timber Particle Board
Liner:	Hardwood / Softwood / MDF
Stop/Architrave:	Hardwood / Softwood / MDF

 Expanding Fire Door Foam

 Fixing Packer

 20x4mm Intumescent

Title Steel/Timber Stud Partition or Masonry Wall

Code FD30 Fire Door Expanding Foam

Sheet 1 of 1 Date 25/02/2020

Issue 2 Dwg No FZD0759