

FS- 01

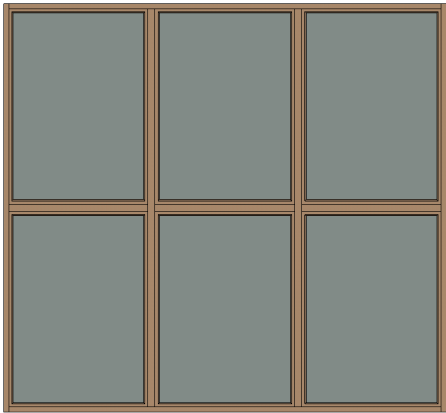

- Non-combustible
Glass packer

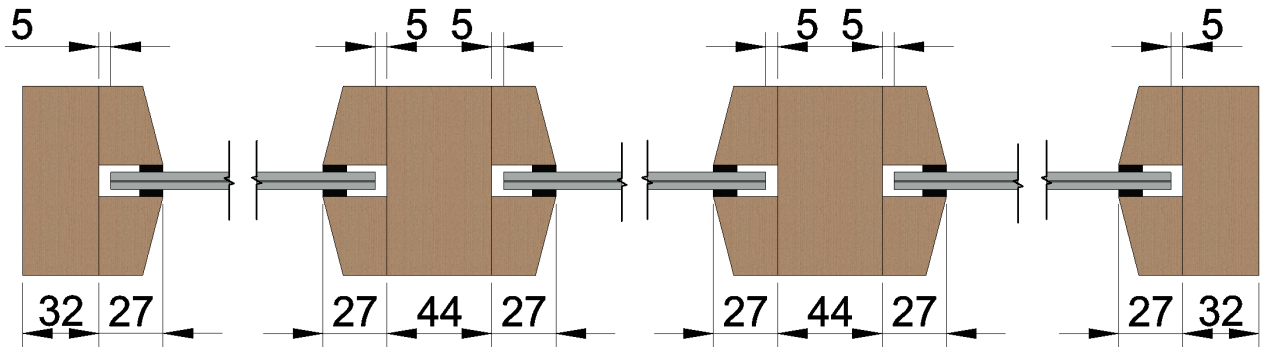
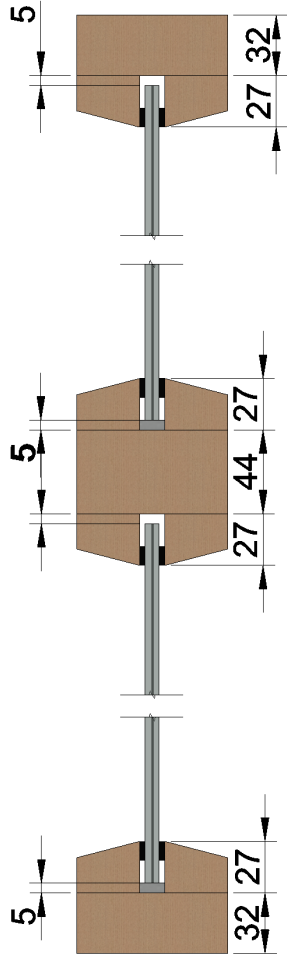
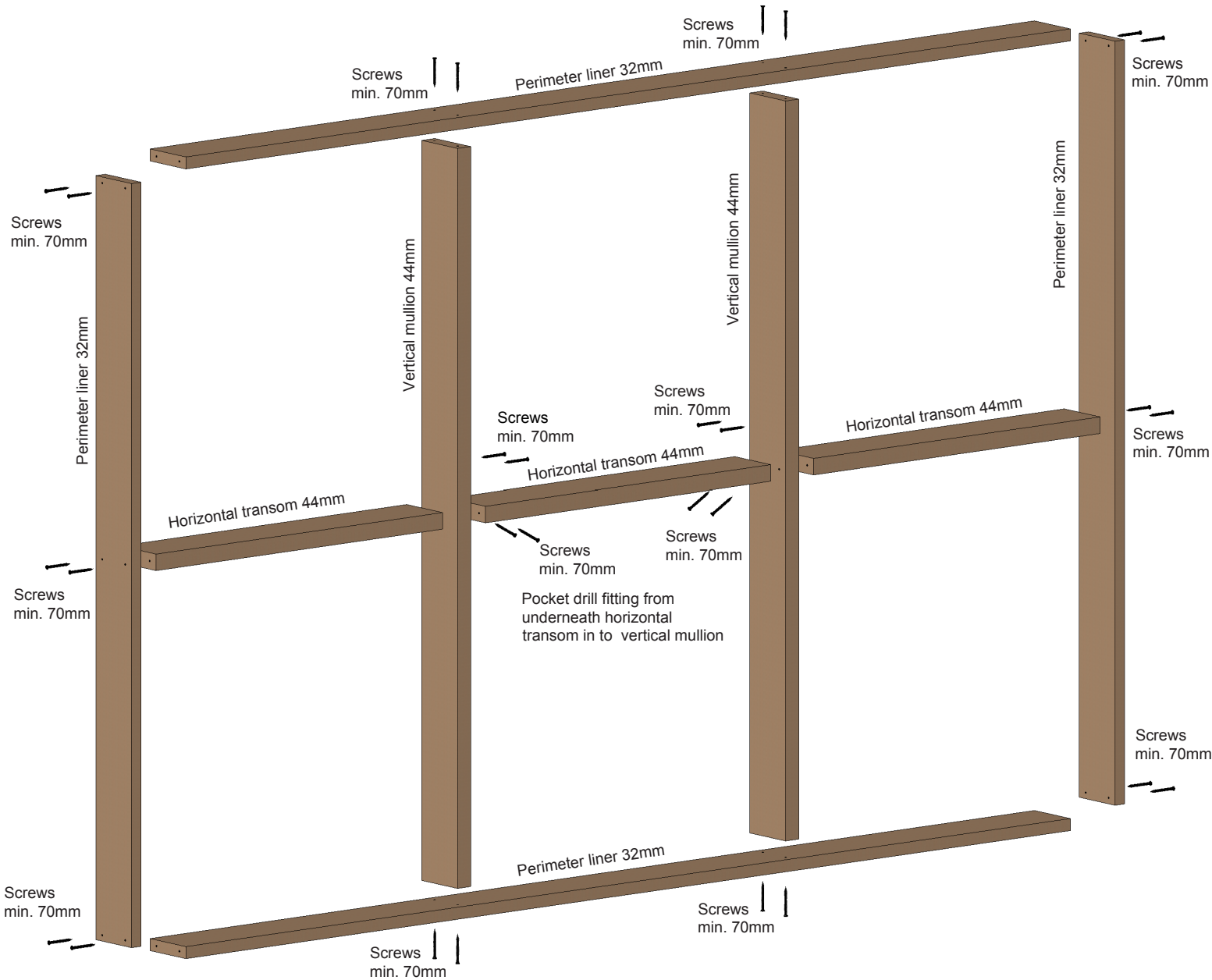

forza-doors.com
01403 711 126
info@forza-doors.com

TITLE ELEVATIONS METHOD OF BUILD
CODE n/a
SHEET 1 of 2

DATE 15/03/2024
ISSUE 1
DWG 1

DESCRIPTION Screen with horizontal
transoms and vertical
mullions

NOTE Drawing to be read
in conjunction page 2
Fitting instructions

IT IS THE CUSTOMER / INSTALLER’S RESPONSIBILITY TO ENSURE THE SUPPORTING CONSTRUCTION IS OF EQUAL OR HIGHER, RATING THAN THE FIRE SCREEN BEING INSTALLED - ALSO TO ENSURE, SUPPORTING CONSTRUCTION & FLOOR ARE AS PLUMB AS POSSIBLE

FITTING INSTRUCTIONS :

- 1 - Survey site location, to determine any special site conditions that may affect installation.
- 2 - Ensure floor is level, if not, pack with suitable non-combustible packers (not supplied), that will support the full weight of the screen (customer / installer responsible) fill any gaps with mineral wool & at least a 10mm bead of intumescent mastic either side. Fire screens must be fitted to the non-combustible slab floor, not on top of carpet or any other flooring covering.
- 3 - Cut & condition liners, assemble frame with suitable fixings & seal with a Class D cross linking wood glue. Ensure framework is correct size as ordered.
- 4 - Insert the assembled frame into location, ensuring framework is plumb, using an accurate calibrated laser level.
- 5 - Fix framework to supporting construction, to all 4 edges, refer to note 8 & supporting construction embedment
- 6 - Use non-combustible packers when fixing frame to supporting construction, to keep framework square. Not supplied. These can be plastic, timber or Blue60 packers.
- 7 - Seal framework to supporting construction, using a suitable sealant relevant to Gap & fire rating (refer to fire stopping sheet for the fire rating needed) to the top & both sides of the screen / supporting construction. Apply architraves to cover seal arrangement.
- 8 - Cut glazing beads, to the front face firstly, ensuring front face alignment & apply CC Foam, taking care not to stretch out.
- 9 - Fix beads into place, using 38mm Steel pins / screws for FD30 - 58mm steel pins . Screws for FD60 50mm from corners & maximum of 250mm centres (at 30 degrees to glass)
- 10 - Survey accurately for the glass, allowing 5mm at each side (inside screen size 1000 x 1000mm = glass size 990 x 990mm) these gaps are critical to allow for expansion.
- 11 - Ensure framework is clean, dry & free from any chemicals, debris before applying glass panes.
- 12 - Install glass onto non-combustible setting blocks (not supplied), 100mm from corners & central in mullion.no more than 5mm thick, these can be plastic.
- 13 - Cut rear glazing beads, apply CC Foam & fit into place, ensuring to apply good pressure on glass, using fixings stated in point 9.
- 14 - If butt jointed glass, use Dow corning fire stop 700 silicone, maximum 5mm gap, in black, white or grey only.
- 15 - If a door is included within a screen, please refer to the fire certificate for fitting instructions. An independent door frame or 2 x 32mm vertical mullions & horizontal transoms may be required.
- 16 - After the Screen(s) have been fully installed, a fire screen certification label will need to be placed on the glass, on the opposite side to the glass kitemark.

NOTES :

- 1 - Do not allow any contact of the glazing edge with water or chemicals.
- 2 - Avoid all glass to metal contact.
- 3 - Do not exercise any restraint on the glazing.
- 4 - Do not damage the glazing edges or the protective tape.
- 5 - Do not install in locations where the glass temperature in normal circumstances may exceed 45 C
- 6 - Please see the Forza cleaning & Maintenance of glazed screens document.
- 7 - For single off set glazed (to one face) and double glazed, an independent door frame (if required) or 2 x 32mm vertical mullions & horizontal transoms will be required.
- 8 - Perimeter fixing to be 50-150mm from corners & no less than 600mm centres - see * for embedment.
- 9 - If FD30, please read this in conjunction with, FD30 bead & liner summary, fixing options, fire stopping options.
- 10 - If for FD60, please read this in conjunction with, FD60 bead & liner summary, fixing options, fire stopping options.

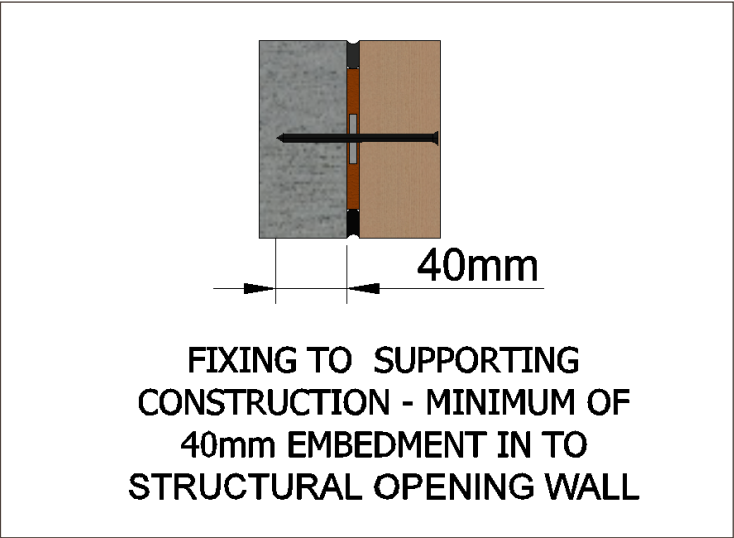

forza-doors.com
01403 711 126
info@forza-doors.com

TITLE	ELEVATIONS METHOD OF BUILD
CODE	n/a
SHEET	1 of 2

DATE	15/03/2024
ISSUE	1
DWG	1

DESCRIPTION	FITTING INSTRUCTIONS
-------------	----------------------

NOTE	Drawing to be read in conjunction page 2 Fitting instructions
------	---