

NSP EPIC - FD30

Isometric

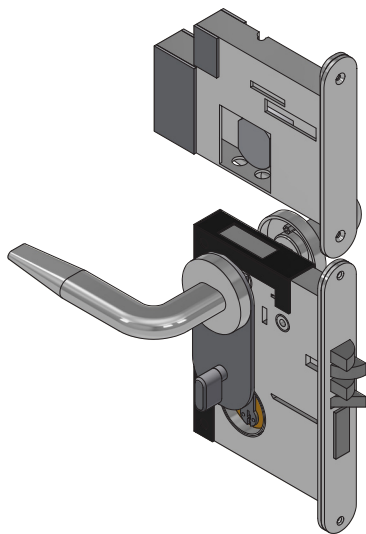

Perspective



Plan

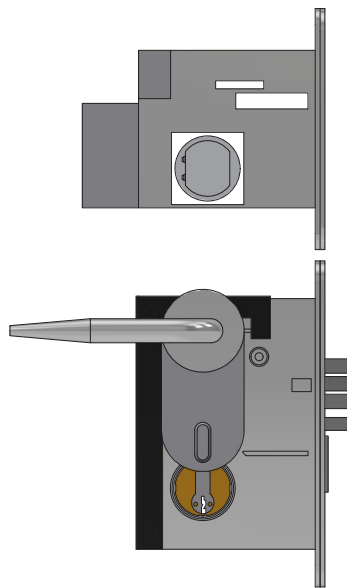

Front

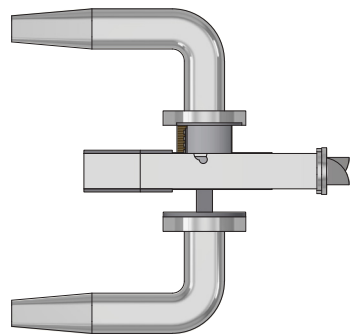

Specification

Door: 44 or 54mm FCS or FCH cores only
No over panels permitted

1mm thick MAP intumescent Protection to both faces of latch body, card reader box & rear of forend & strike.

Title	NSP EPIC - FD30		
Code			
Sheet	1 of 2	Date	11/01/2022
Issue	1	Dwg No	FZD5118

NSP EPIC - FD30

Exploded View

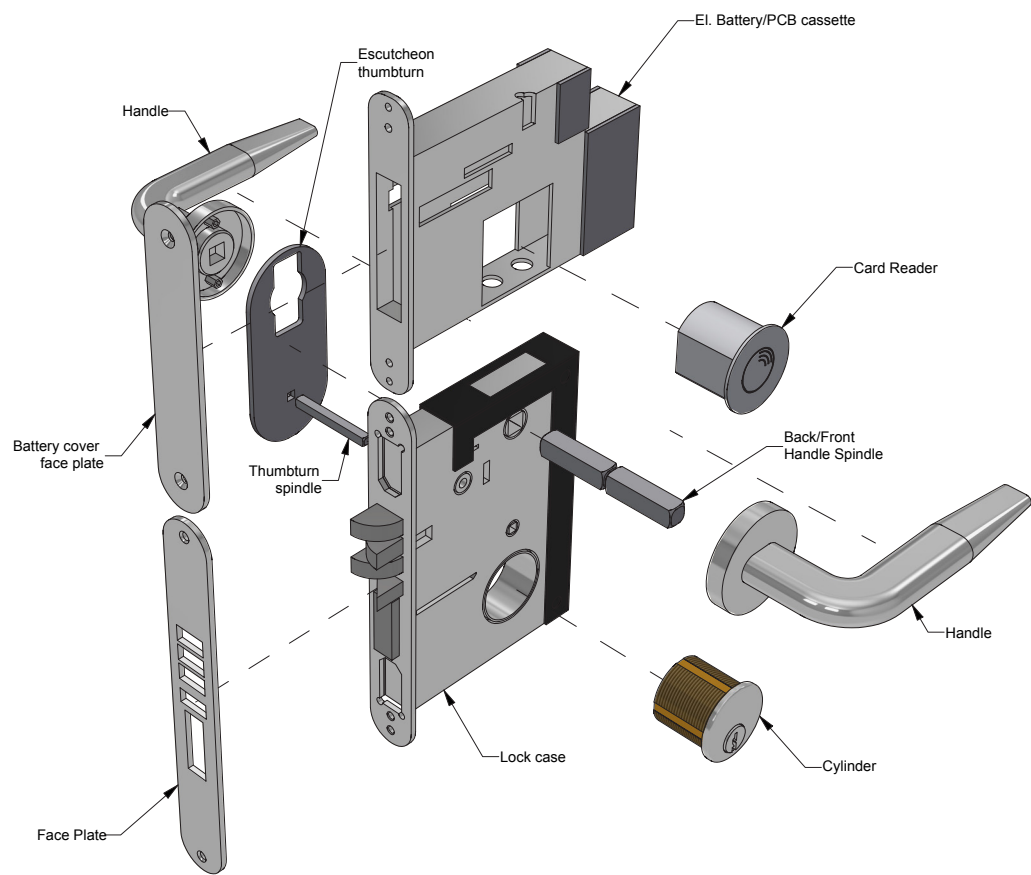

*Lock Details For Illustrative Purpose Only.

Specification

Door: 44 or 54mm FCS or FCH cores only
No over panels permitted

1mm thick MAP intumescent Protection to both faces of latch body, card reader box & rear of forend & strike.

Title	NSP EPIC - FD30		
Code			
Sheet	2 of 2	Date	11/01/2022
Issue	1	Dwg No	FZD5118