

FD60 FIRE DOOR EXPANDING FOAM

STEEL/TIMBER STUD PARTITION OR MASONRY WALL

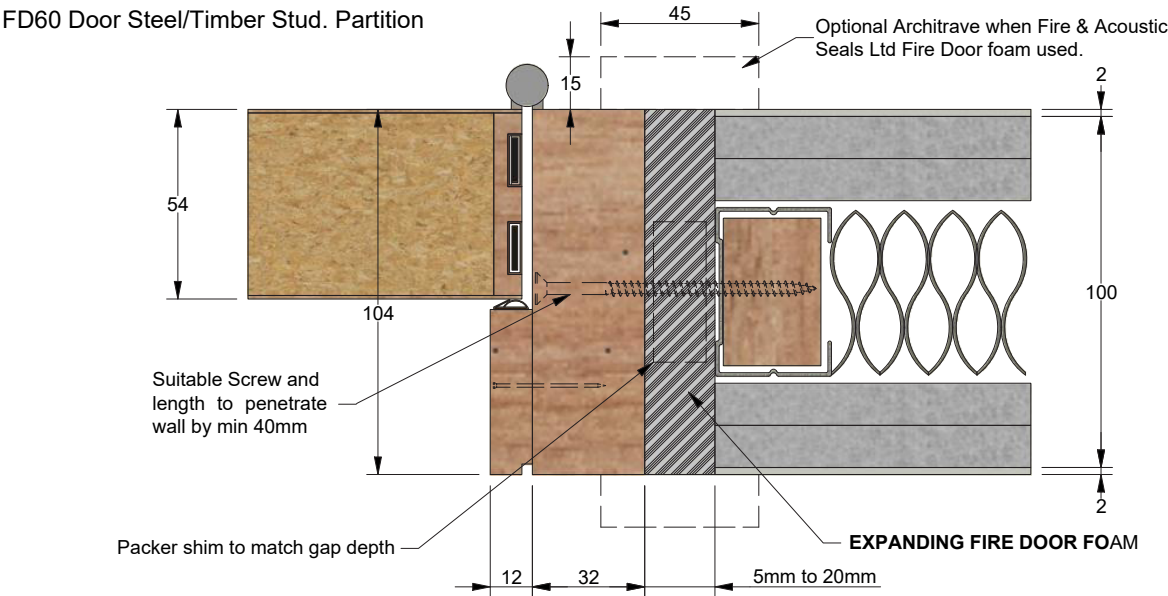

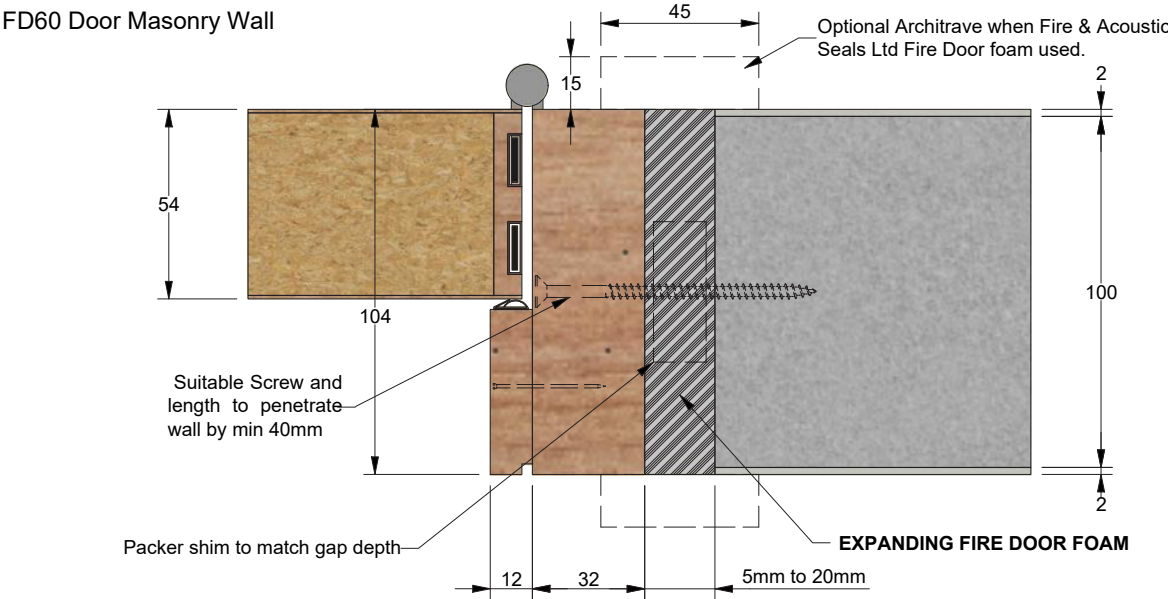

***Forza Recommended Foams:**
 Fire And Acoustic Seals Ltd. > Fire Door Foam: Hardwood With or Without Architraves. (MDF With 19mm Architraves)
 Sealed Tight Solutions Ltd. > ST99 FR Expanding Foam: Only With Architraves. (Max 10mm Gap)

Other manufacturers foams that have been tested in accordance with BS476-20 or BS EN 1366-4 in suitable supporting constructions with or without architraves may be suitable. (contact the foam supplier /manufacturer for evidence)



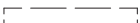

Specification

Door:	Timber Particle Board
Liner:	Hardwood / MDF
Stop/Architrave:	Hardwood / MDF
	Expanding Fire Door Foam

	Fixing Packer
	15x4mm Intumescent

Title	Steel/Timber Stud Partition or Masonry Wall		
Code	FD60 Fire Door Expanding Foam		
Sheet	1 of 1	Date	25/02/2020
Issue	2	Dwg No	FZD0760



 forza-doors.com
 01403 711 126
 sales@forza-doors.com